

## StoVentec Carrier-Board Facade

StoVentec C: Maximum design variety with ceramics

The StoVentec Carrier-Board Facade is successfully used both in the construction of new buildings and in refurbishment. It provides a quick and high-quality solution especially for moist or extreme substrates with glazed brick slips or other ceramic claddings as the top layer. Thanks to ventilation of the system, the masonry and insulation remain permanently dry, protected and functional. The multilayer structure also adds to improved sound protection.

# StoVentec C

## Stylistically confident with ceramics

Whether modern new buildings, listed buildings or the extension of existing buildings - ceramic facade claddings do not only reflect the desired style and particular spirit of the time in a perfect manner, they also offer a great variety of formats, shapes, textures and colours for ventilated rainscreen facades. The carrier board of the StoVentec C system forms an excellent adhesion primer for ceramics and glazed brick slips. Besides ceramic coverings and StoDeco profiles and rustications, the carrier board is also suited for the application of glass (StoVentec G), glass mosaic (StoVentec M), render (StoVentec R) and natural stone panel tiles (StoVentec S).



**Hotel Messerschmitt, Bamberg, Germany**  
Architect: Architectural office Seemüller, Bamberg, Germany

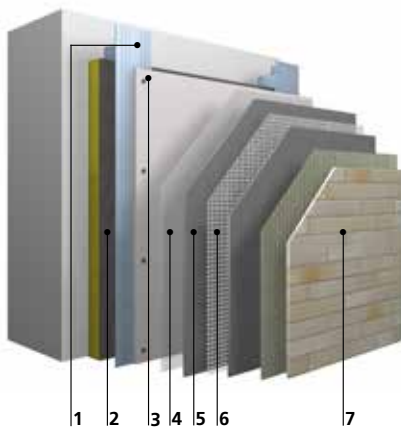

**StoVentec C  
system build-up**

- 1 Sub-construction
- 2 Insulation
- 3 Carrier board
- 4 Primer
- 5 Base coat
- 6 Reinforcing coat with glass fibre mesh
- 7 Top coat:  
glazed brick slips/ceramics

## Overview of StoVentec C

### Area of application:

- Existing and new buildings. Installation limits according to national building regulations
- Wall structures: masonry (concrete, lime sandstone, brick, porous concrete), concrete slab construction (three-layer concrete slab) and fair-faced masonry
- Levels unevenness by means of a flexible sub-construction
- Onto external walls in timber construction

### Properties:

- Lowest thermal bridge coefficients due to own sub-construction made from a combination of stainless steel and aluminium
- Improvement of up to 10 dB (A) in the airborne sound insulation index
- Highly effective thermal insulant
- Highly weather-resistant
- Limited combustibility
- Non-combustible with StoVentec Carrier Board A and mineral coating procedure (A2 s1 d0 in accordance with DIN EN 13501 after permission from the responsible authority where necessary)
- Very high crack resistance
- Highly resistant to mechanical stress

### Appearance:

- StoSilt Glazed Brick Slips
- Ceramics
- Can be combined with StoDeco Facade Profiles and StoDeco Rustications

### Application:

- Complete detail solutions
- Fast installation
- Curvatures can be implemented

### Approvals:

The relevant European and/or national approvals apply.

### Head office

Sto SE & Co. KGaA

### Market Development

Ehrenbachstrasse 1  
79780 Stuehlingen  
Germany

Phone +49 7744 57-1131

Fax +49 7744 57-2428

infoservice@sto.com

www.sto.com



The detailed technical specifications and information on the products contained in the Technical Data Sheets and approvals must be observed.